

SLA52 Rod Actuators



FEATURES

- 52mm Diameter
- No Load Speed up to 39.2mm/s
- Max Load up to 130kg (287lb)
- Max Load Speed up to 34.1mm/s (1.34in/sec)
- Stroke Length up to 300mm (11.8in)
- IP54 Protection



SPECIFICATIONS

Series #	Stroke Length (mm)	Load Capacity (kg)	No Load Speed (mm/s)	Max Load Speed (mm/s)	Voltage (VDC)	Gear Ratios	Self Locking Force (kg)
SLA52-150-17-24-B-01	150	12	34.1	28.8	24	17:1	25
SLA52-150-51-24-B-01	150	50	11.1	9.4	24	51:1	90
SLA52-150-100-24-B-01	150	130	5.8	4.8	24	100:1	160
SLA52-200-17-24-B-01	200	12	34.1	28.8	24	17:1	25
SLA52-200-51-24-B-01	200	50	11.1	9.4	24	51:1	90
SLA52-200-100-24-B-01	200	130	5.8	4.8	24	100:1	160
SLA52-250-25-24-B-01	250	25	22.5	19	24	25:1	50
SLA52-250-51-24-B-01	250	50	11.1	9.4	24	51:1	90
SLA52-250-100-24-B-01	250	130	5.8	4.8	24	100:1	160
SLA52-300-25-24-B-01	300	25	22.5	19	24	25:1	50
SLA52-300-51-24-B-01	300	50	11.1	9.4	24	51:1	90
SLA52-300-100-241-B-01	300	130	5.8	4.8	24	100:1	160

ORDERING INFORMATION

SLA52-100-100-24-B-01

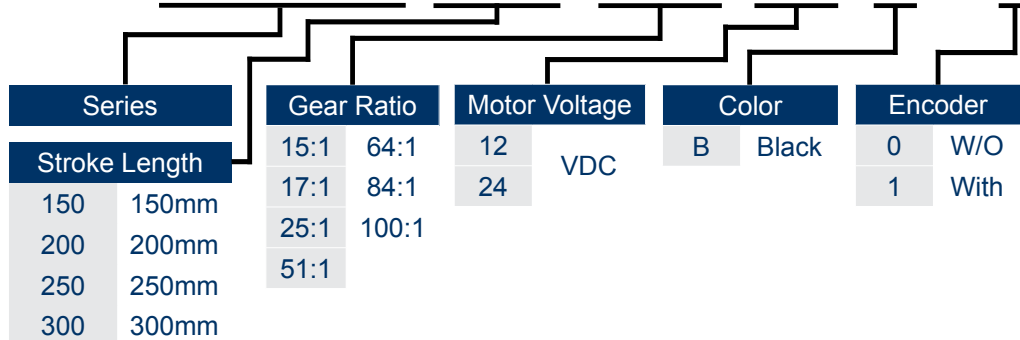

L011263

DIMENSIONS

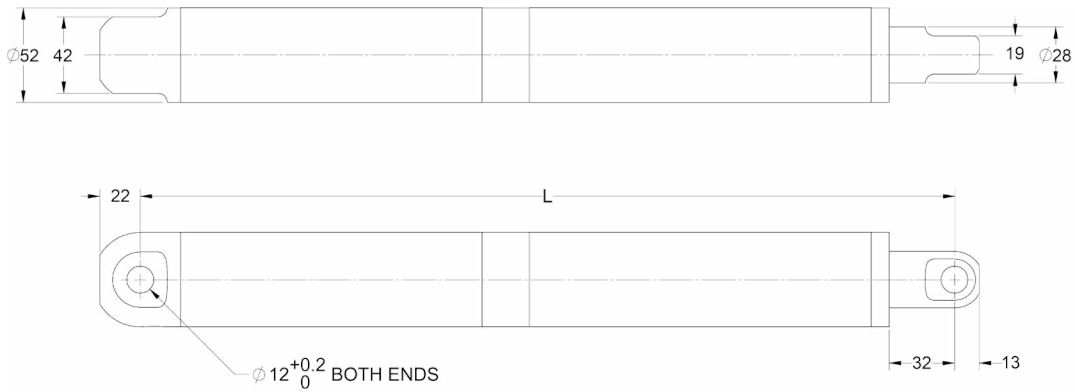

$$L = S(\text{Stroke Length}) + 274(\text{mm})$$

SPECIFICATIONS

Gear Ratio	15:1	17:1	25:1	51:1	64:1	84:1	100:1
No Load Speed (mm/s)	39.2	34.1	22.5	11.1	9.0	6.8	5.8
Max Load Speed (mm/s)	34.1	28.8	19	9.4	7.4	5.6	4.8
Load Capacity (kg)	7	12	25	50	70	100	130
Self Locking Force (kg)	15	25	50	90	120	130	160
Stroke Length (mm)	150, 200, 250, 300						
Duty Cycle	Max 10%						
Temperature Range	-10°C ~ 60°C						
IP Grade	IP54						

TORQUE CURVES

